

MATERIAL PROPERTIES

GALVANISED STEEL	Strip galvanised metal EN 10142 DX51-Z275
STAILESS STEEL	Stainless steel 1.4301 (V2A)

APPLICATION PURPOSE

Components for the protection of buildings against the infiltration of water in sensitive areas such as doors and façades on terraces, rooftops, balconies or any other open surface in accordance with german flat roof building regulation, DIN 18195 and DIN 18040, part 1 and 2.

DIFFERENT TYPES

- / Lengths 500, 1000 and 2000 mm
- / Length 1000 including outlet connector
- / Fixed construction heights 55, 70, 90 and 100 mm
- / Adjustable construction heights 55-90 and 90-150 mm

PRODUCT INFORMATION

- / Drainage system with bottom part slotted on both sides (integrated gravel border), without loose parts
- / Precise height adjustment to the surface level, also possible after installation and after lowering of the gravel bed
- / Easy installation by channel plug-system
- / Increased wall-sided rear ventilation wall-sided – quick dry off of waterlogging
- / Increased outlet capacity, according to DIN EN 12056-3 and DIN 1986-100 due to intelligent slot geometry
- / Optimised connection of relief channel
- / Sturdy construction thanks to a standard lateral reinforcement of the channel bodies
- / Application in compliance with the flat roof guideline and DIN 18195-5
- / Possibility of accessible entrances as the height can be adjusted on one side
- / Wide range of standard and design gratings
- /

ACCESSORIES

- / Top section with adjustable construction height 55-90 mm as cover for point drainage
- / Top section with adjustable construction height 90-150 mm as cover for point drainage
- / Relief channel as drainage below surface layers
- / End cap with fixed heights 55, 70, 90, 100 mm
- / End cap with adjustable heights 55-90 and 90-150 mm
- / Cover fixing bolts



INSTALLATION INSTRUCTIONS

MEATEC Einbaubeispiel für barrierefreies Bauen gemäß DIN 18040 Teil 1 & 2 und Flachdachrichtlinie, Abs. 4.4 (3), (Warmdach)

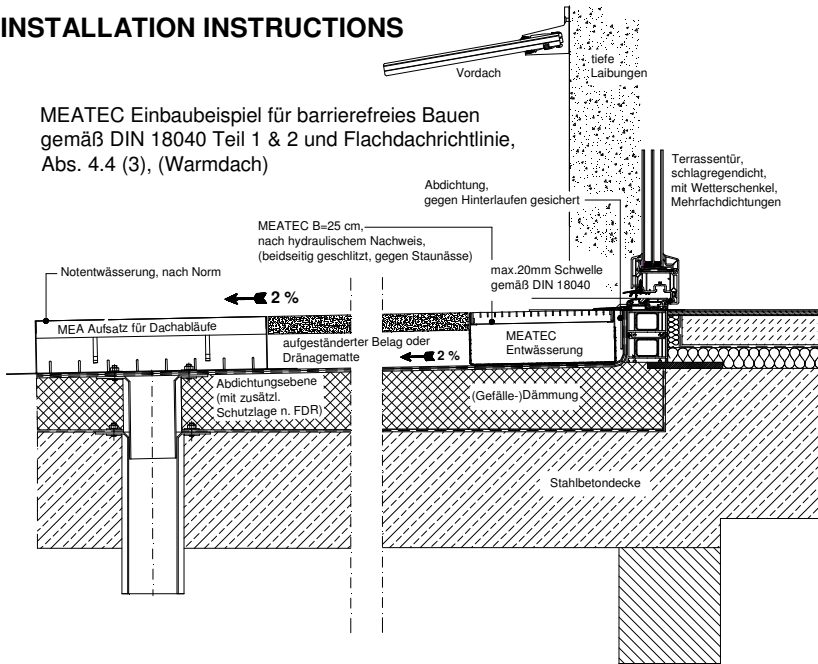

MEATEC Einbaubeispiel 5 cm Anschlusshöhe über Oberfläche Belag, gemäß Flachdachrichtlinie, Abs. 4.4 (2), (Warmdach)

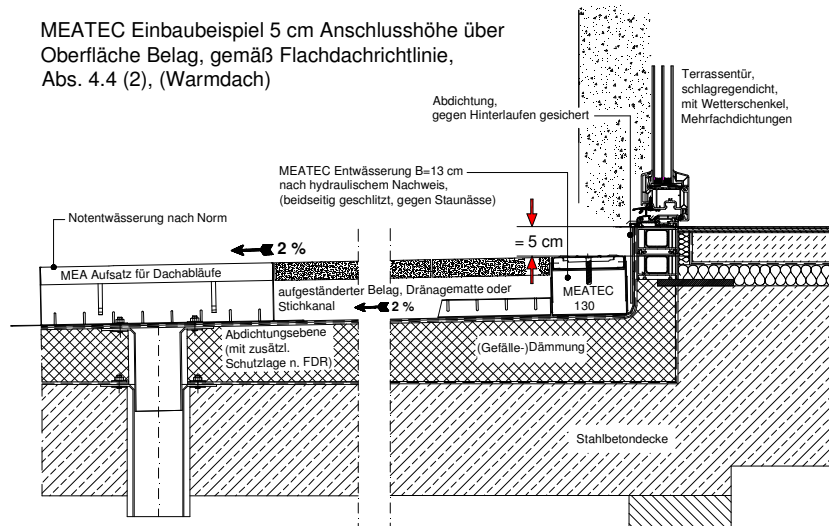

MEATEC Einbaubeispiel 15 cm Anschlusshöhe über Oberfläche Belag, gemäß Flachdachrichtlinie, Abs. 4.4 (1), (Warmdach)

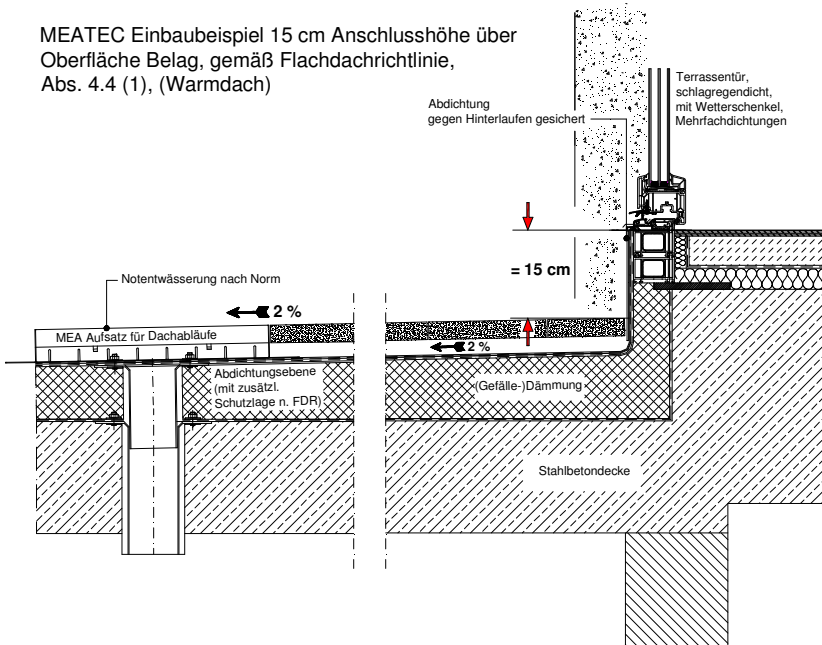

MEATEC V and E 130

Can be walked on, accessible for wheelchairs clear width 130

DRAINAGE FOR TERRACE AND AT FACADES MADE OF GALVANISED OR STAINLESS STEEL, FIXED CONSTRUCTION HEIGHTS

Drainage system made of galvanised or stainless steel, with slots on both sides (integrated gravel border). For installation according to the flat roof guideline and DIN 18195. Can be walked on and accessible for wheelchairs.

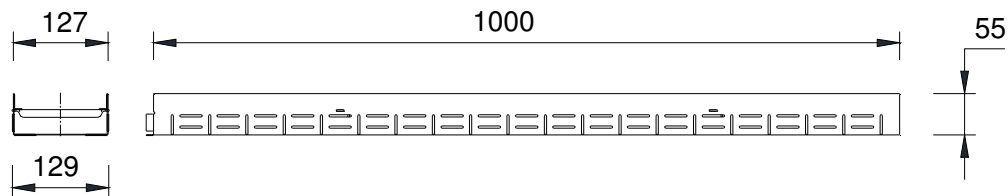

MEATEC 130 CHANNEL UNIT, FIXED HEIGHTS, GALVANISED AND STAINLESS STEEL

Description galvanised steel	EDP-No. galvanised 010...	Description stainless steel	EDP-No. stainl. steel 010...	length in mm	total height in mm	kg/unit
MEATEC V 130-F55	730026	MEATEC E 130-F55	730044	2000	55	4,60
MEATEC V 130-F55	730028	MEATEC E 130-F55	730046	1000	55	2,30
MEATEC V 130-F55	730030	MEATEC E 130-F55	730048	500	55	1,20
MEATEC V 130-F70	730032	MEATEC E 130-F70	730050	2000	70	5,10
MEATEC V 130-F70	730034	MEATEC E 130-F70	730052	1000	70	2,60
MEATEC V 130-F70	730036	MEATEC E 130-F70	730054	500	70	1,30
MEATEC V 130-F90	730208	MEATEC E 130-F90	730218	2000	90	5,70
MEATEC V 130-F90	730210	MEATEC E 130-F90	730220	1000	90	2,90
MEATEC V 130-F90	730214	MEATEC E 130-F90	730224	500	90	1,40
MEATEC V 130-F100	730228	MEATEC E 130-F100	730238	2000	100	6,00
MEATEC V 130-F100	730230	MEATEC E 130-F100	730240	1000	100	3,00
MEATEC V 130-F100	730234	MEATEC E 130-F100	730244	500	100	1,50

MEATEC V and E 130

Can be walked on, accessible for wheelchairs clear width 130

DRAINAGE FOR TERRACE AND AT FACADES MADE OF GALVANISED OR STAINLESS STEEL, ADJUSTABLE CONSTRUCTION HEIGHTS

Drainage system made of galvanised or stainless steel, with slots on both sides (integrated gravel border). For installation according to the flat roof guideline and DIN 18195. Can be walked on and accessible for wheelchairs.

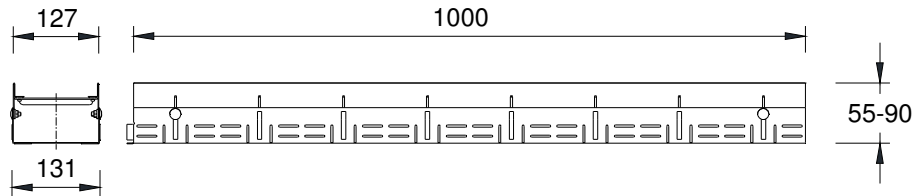

MEATEC 130 CHANNEL UNIT, ADJUSTABLE HEIGHTS, GALVANISED AND STAINLESS STEEL

Description galvanised steel	EDP-No. galvanised 010...	Description stainless steel	EDP-No. stainl. steel 010...	length in mm	total height in mm	kg/unit
MEATEC V 130-V55-90	730002	MEATEC E 130-V55-90	730014	2000	55-90	5,70
MEATEC V 130-V55-90	730004	MEATEC E 130-V55-90	730016	1000	55-90	2,90
MEATEC V 130-V55-90	730006	MEATEC E 130-V55-90	730018	500	55-90	1,50
MEATEC V 130-V90-150	730008	MEATEC E 130-V90-150	730020	2000	90-150	7,70
MEATEC V 130-V90-150	730010	MEATEC E 130-V90-150	730022	1000	90-150	3,90
MEATEC V 130-V90-150	730012	MEATEC E 130-V90-150	730024	500	90-150	2,00

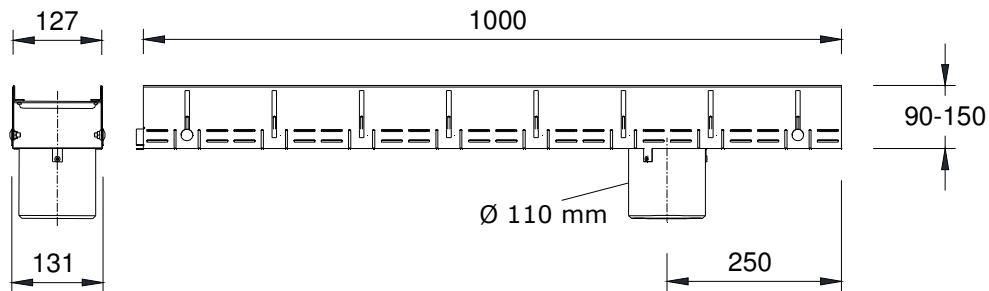

MEATEC 130 CHANNEL UNIT WITH VERTICAL OUTLET CONNECTOR Ø 110 MM, FIXED AND ADJUSTABLE HEIGHTS, GALVANISED AND STAINLESS STEEL

Description galvanised steel	EDP-No. galvanised 010...	Description stainless steel	EDP-No. stainl. steel 010...	length in mm	total height in mm	kg/unit
MEATEC V 130-F55/A	730200	MEATEC E 130-F55/A	730202	1000	55	2,50
MEATEC V 130-F70/A	730204	MEATEC E 130-F70/A	730206	1000	70	2,80
MEATEC V 130-F90/A	730212	MEATEC E 130-F90/A	730222	1000	90	3,10
MEATEC V 130-F100/A	730232	MEATEC E 130-F100/A	730242	1000	100	3,20
MEATEC V 130-V55-90/A	730644	MEATEC E 130-V55-90/A	730646	1000	55-90	3,10
MEATEC V 130-V90-150/A	730648	MEATEC E 130-V90-150/A	730650	1000	90-150	4,10

MEATEC V and E 130

Can be walked on, accessible for wheelchairs clear width 130

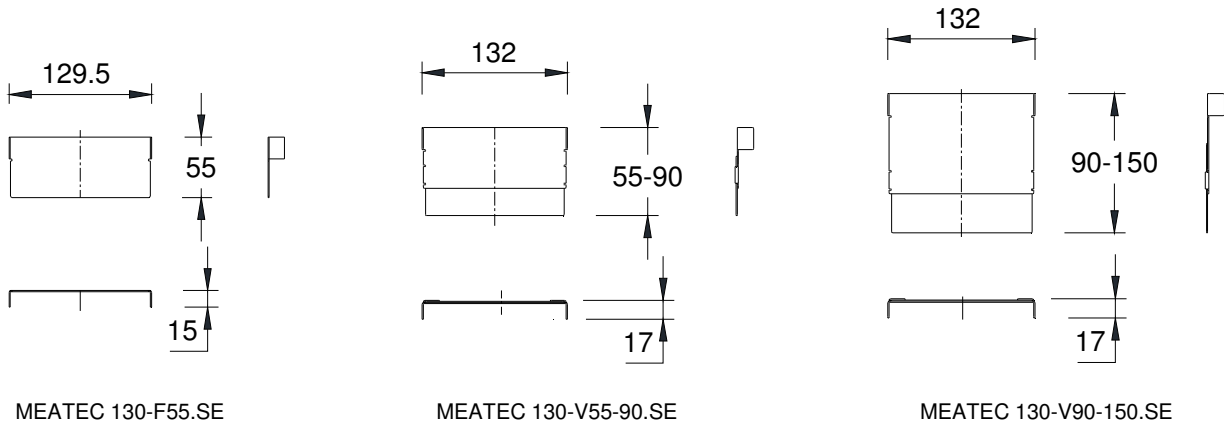

MEATEC 130 END CAPS, FIXED AND ADJUSTABLE HEIGHTS

Description galvanised steel	EDP-No. galvanised 010...	Description stainless steel	EDP-No. stainl. steel 010...	total height in mm	kg/unit
MEATEC V130-F55.SE End cap	730158	MEATEC E130-F55.SE End cap	730170	55	0,06
MEATEC V130-F70.SE End cap	730160	MEATEC E130-F70.SE End cap	730172	70	0,08
MEATEC V130-F90.SE End cap	730216	MEATEC E130-F90.SE End cap	730226	90	0,12
MEATEC V130-F100.SE End cap	730236	MEATEC E130-F100.SE End cap	730246	100	0,12
MEATEC V130-V55-90.SE End cap	730162	MEATEC E130-V55-90.SE End cap	730174	55-90	0,12
MEATEC V130-V90-150.SE End cap	730164	MEATEC E130-V90-150.SE End cap	730176	90-150	0,20

MEATEC STANDARD AND DESIGN GRATINGS, GALVANISED AND STAINLESS STEEL

Suitable for MEATEC 130, construction width 122 mm, can be walked on and accessible for wheelchairs; cover fixing optional.

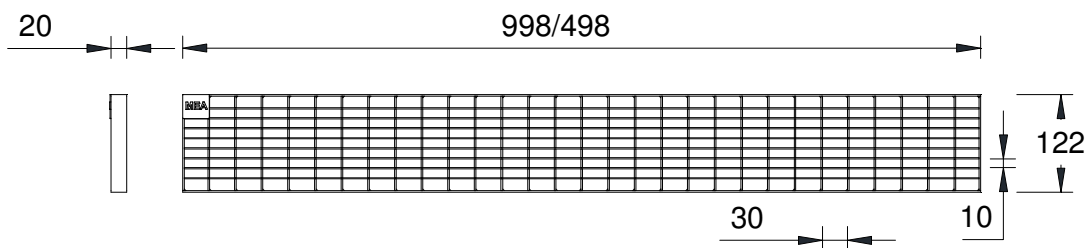

MEATEC 130 MESH GRATING 30/10, GALVANISED AND STAINLESS STEEL, CAN BE WALKED ON AND ACCESSIBLE FOR WHEELCHAIRS

Description galvanised steel	EDP-No. galvanised 010...	Description stainless steel	EDP-No. stainl. steel 010...	length in mm	Inlet sect. area Ø cm ² /m	kg/unit
MEATEC V 130 mesh grating 30/10	730090	MEATEC E 130 mesh grating 30/10	730126	1000	845	2,90
MEATEC V 130 mesh grating 30/10	730092	MEATEC E 130 mesh grating 30/10	730128	500	845	1,45

MEATEC V and E 130

Can be walked on, accessible for wheelchairs clear width 130

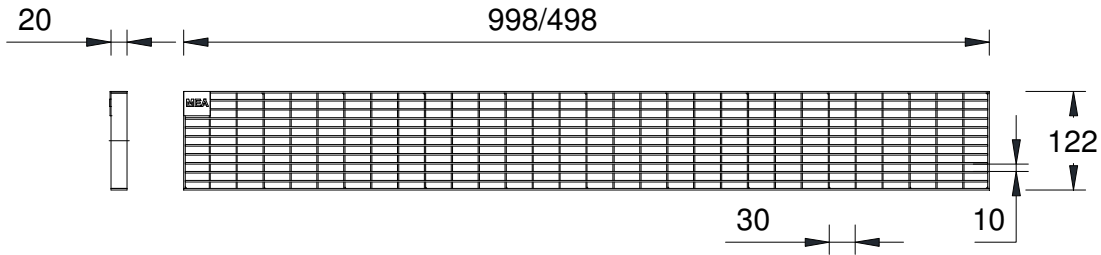

MEATEC 130 LONGITUDINAL SLOTTED GRATING, GALVNISED AND STAINLESS STEEL, CAN BE WALKED ON AND ACCESSIBLE FOR WHEELCHAIRS

Description galvanised steel	EDP-No. galvanised 010...	Description stainless steel	EDP-No. stainl. steel 010...	length in mm	Inlet sect. area Ø cm ² /m	kg/unit
MEATEC V 130 longitudinal slotted grating	730748	MEATEC E 130 longitudinal slotted grating	730752	1000	985	4,30
MEATEC V 130 longitudinal slotted grating	730750	MEATEC E 130 longitudinal slotted grating	730754	500	985	2,15

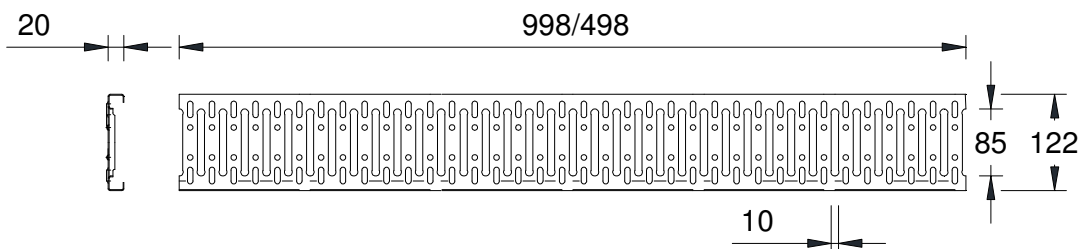

MEATEC 130 SLOTTED GRATING 10/85, GALVNISED AND STAINLESS STEEL, CAN BE WALKED ON AND ACCESSIBLE FOR WHEELCHAIRS

Description galvanised steel	EDP-No. galvanised 010...	Description stainless steel	EDP-No. stainl. steel 010...	length in mm	Inlet sect. area Ø cm ² /m	kg/unit
MEATEC V 130 slotted grating 10/85	730086	MEATEC E 130 slotted grating 10/85	730122	1000	280	1,40
MEATEC V 130 slotted grating 10/85	730088	MEATEC E 130 slotted grating 10/85	730124	500	280	0,80

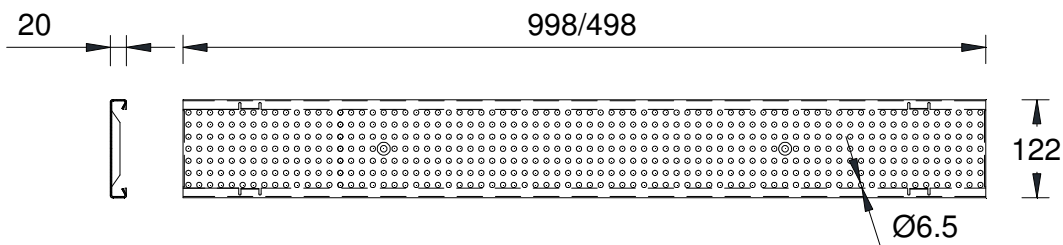

MEATEC 130 PERFORATED GRATING Ø 6,5 MM, GALVNISED AND STAINLESS STEEL, CAN BE WALKED ON AND ACCESSIBLE FOR WHEELCHAIRS

Description galvanised steel	EDP-No. galvanised 010...	Description stainless steel	EDP-No. stainl. steel 010...	length in mm	Inlet sect. area Ø cm ² /m	kg/unit
MEATEC V 130 perforated grating	730098	MEATEC E 130 perforated grating	730134	1000	170	1,60
MEATEC V 130 perforated grating	730100	MEATEC E 130 perforated grating	730136	500	170	0,80

MEATEC V and E 130

Can be walked on, accessible for wheelchairs clear width 130

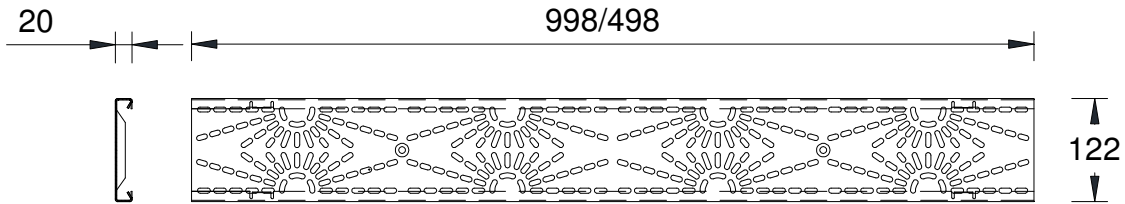

MEATEC 130 DESIGN GRATING „RAYS“, GALVNISED AND STAINLESS STEEL, CAN BE WALKED ON AND ACCESSIBLE FOR WHEELCHAIRS

Description galvanised steel	EDP-No. galvanised 010...	Description stainless steel	EDP-No. stainl. steel 010...	length in mm	Inlet sect. area Ø cm ² /m	kg/unit
MEATEC V 130 design grating RAYS	730102	MEATEC E 130 design grating RAYS	730138	1000	218	1,40
MEATEC V 130 design grating RAYS	730104	MEATEC E 130 design grating RAYS	730140	500	218	0,70

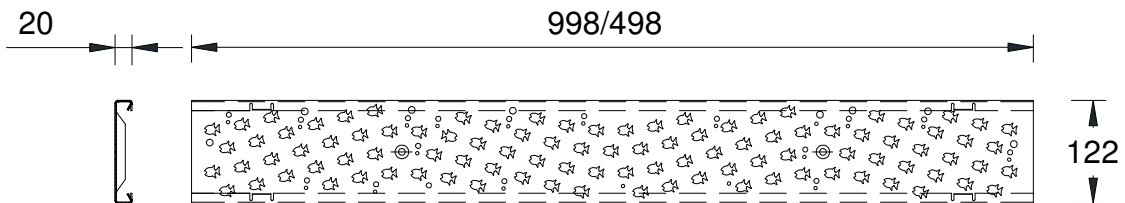

MEATEC 130 DESIGN GRATING „FISH“, GALVNISED AND STAINLESS STEEL, CAN BE WALKED ON AND ACCESSIBLE FOR WHEELCHAIRS

Description galvanised steel	EDP-No. galvanised 010...	Description stainless steel	EDP-No. stainl. steel 010...	length in mm	Inlet sect. area Ø cm ² /m	kg/unit
MEATEC V 130 design grating FISH	730106	MEATEC E 130 design grating FISH	730142	1000	150	1,40
MEATEC V 130 design grating FISH	730108	MEATEC E 130 design grating FISH	730144	500	150	0,70

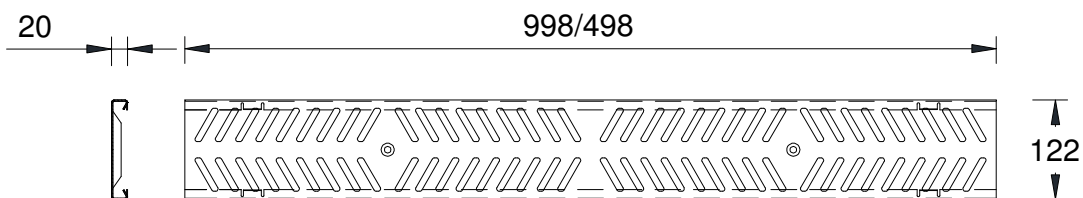

MEATEC 130 DESIGN GRATING „RALLYE“, GALVNISED AND STAINLESS STEEL, CAN BE WALKED ON AND ACCESSIBLE FOR WHEELCHAIRS

Description galvanised steel	EDP-No. galvanised 010...	Description stainless steel	EDP-No. stainl. steel 010...	length in mm	Inlet sect. area Ø cm ² /m	kg/unit
MEATEC V 130 design grating RALLYE	730110	MEATEC E 130 design grating RALLYE	730146	1000	260	1,40
MEATEC V 130 design grating RALLYE	730112	MEATEC E 130 design grating RALLYE	730148	500	260	0,70

MEATEC V and E 130

Can be walked on, accessible for wheelchairs clear width 130

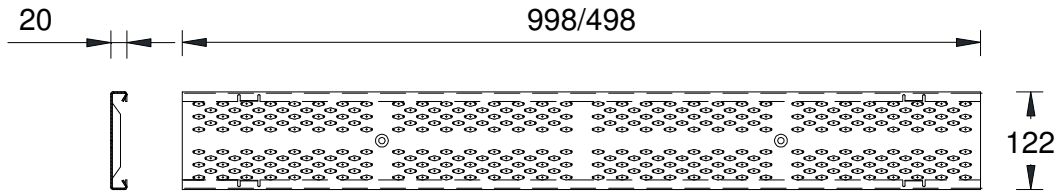

MEATEC 130 DESIGN GRATING „LOZENGE“, GALVNISED AND STAINLESS STEEL, CAN BE WALKED ON AND ACCESSIBLE FOR WHEELCHAIRS

Description galvanised steel	EDP-No. galvanised 010...	Description stainless steel	EDP-No. stainl. steel 010...	length in mm	Inlet sect. area Ø cm ² /m	kg/unit
MEATEC V 130 design grating LOZENGE	730114	MEATEC E 130 design grating LOZENGE	730150	1000	176	1,40
MEATEC V 130 design grating LOZENGE	730116	MEATEC E 130 design grating LOZENGE	730152	500	176	0,70

MEATEC COVER FIXING BOLT

Description	EDP-No. 010...	Material	kg/unit
MEATEC cover fixing bolt V2A	730796	Stainless steel	0,02

MEATEC V and E 130

Can be walked on, accessible for wheelchairs clear width 130

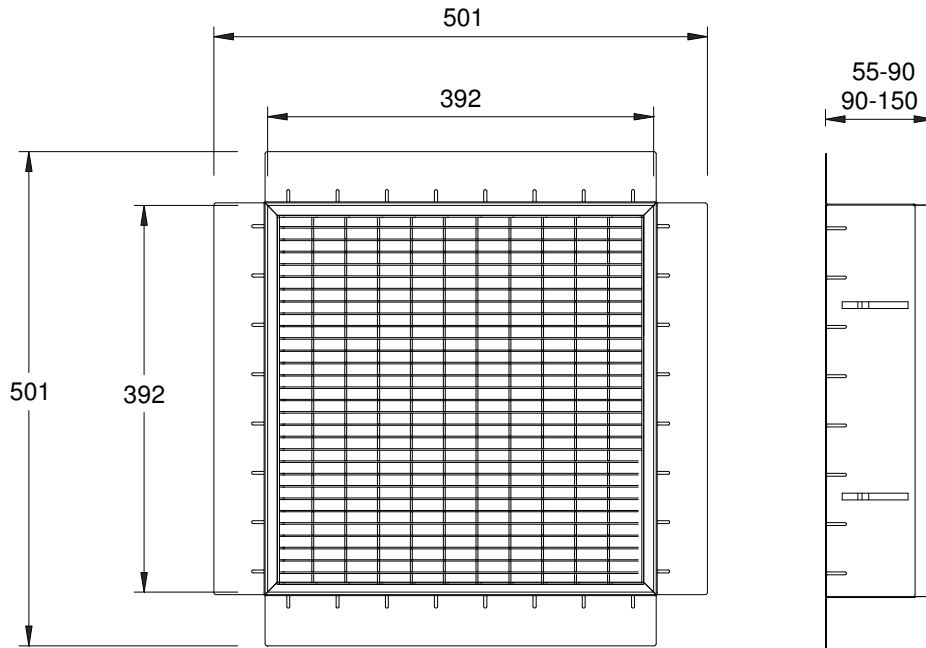

MEATEC TOP SECTION HEIGHT ADJUSTABLE 400 X 400, GALVANISED AND STAINLESS STEEL

Description galvanised steel	EDP-No. galvanised 010...	Description stainless steel	EDP-No. stainl. steel 010...	length in mm	total height in mm	kg/unit
MEATEC V 400x400 top section L + grating 30/10	730182	MEATEC E 400x400 top section L + grating 30/10	730186	400	55-90	6,00
MEATEC V 400x400 top section H + grating 30/10	730184	MEATEC E 400x400 top section H + grating 30/10	730188	400	90-150	6,00

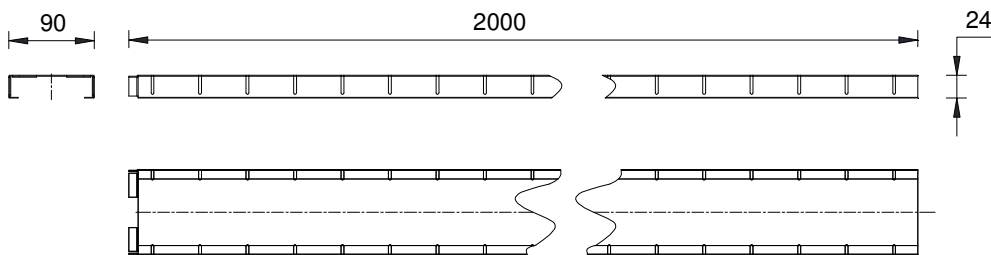

MEATEC RELIEF CHANNEL, GALVANISED AND STAINLESS STEEL

Description galvanised steel	EDP-No. galvanised 010...	Description stainless steel	EDP-No. stainl. steel 010...	length in mm	total height in mm	kg/unit
MEATEC V 90/24-relief channel	730328	MEATEC E 90/24-relief channel	730330	2000	24	4,40

MEA Water Management GmbH
 Sudetenstraße 1
 86551 Aichach
 Tel.: +49 (0) 82 51. 91 0
 Fax: +49 (0) 82 51. 91 13 00
 E-Mail: info.drainage@mea.de
 www.mea-group.com